

ELEVATION

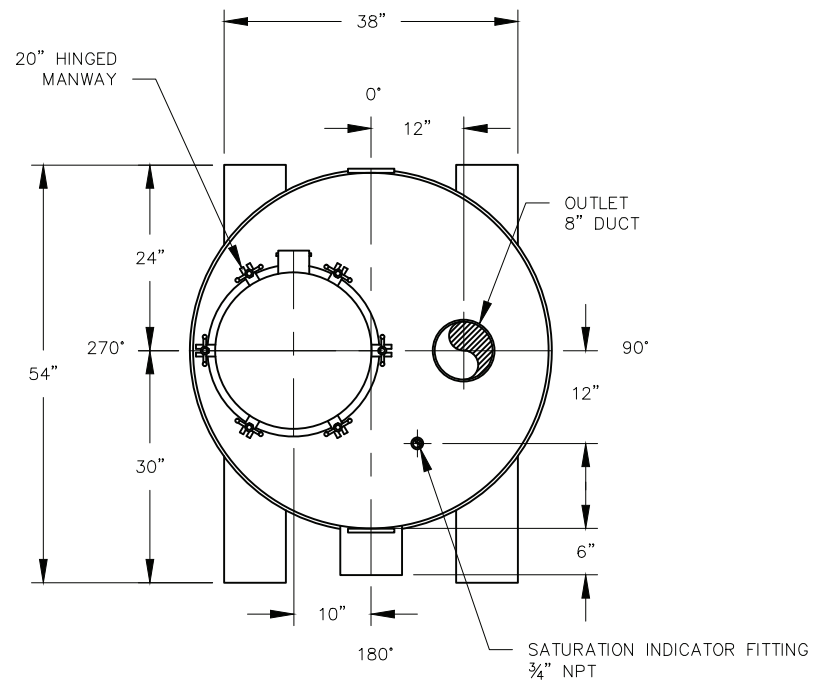

PLAN

\* STAINLESS STEEL BED RETENTION  
PLATE,  
140°F WITH PE PLATE

## VESSEL STANDARDS

VESSEL MATERIALS : SA-36	VESSEL ACCESS : 20" HINGED MANWAY
LINING : EPOXY	LIQUID DRAIN ASSEMBLY : 1" NPT W/ HDPE PLUG
EXTERIOR PAINT : EPOXY BASE W/ URETHANE TOP COAT	MAX. MEDIA FILL : 54 FT <sup>3</sup>
HEAD THICKNESS : 3/16" NOM.	SHIP WT. EMPTY : 1200 LBS
SHELL THICKNESS : 3/16" NOM.	MAX. OPERATING PRESSURE : 15 PSIG
INTERNALS : STAINLESS STEEL PLENUM	MAX. OPERATING TEMPERATURE : 180°F

7	ADD LIFT LUGS	JB	4/11/11
6	UPDATE VESSEL STANDARDS	JB	8/24/10
5	CHANGE MANWAY TO HINGED STYLE	JB	9/6/06
4	REVISE CARBON FILL	JB	1/20/04
3	REMOVE VENT	JB	5/14/03
2	CHANGE EXTERIOR PAINT	JB	5/7/03
1	TITLE BLOCK	JB	1/10/03
NO.	REVISION	BY	DATE

PROJECT	
N-1200-PDB	
PROJ. NO.	SALES
P.O. NO.	
THIS DRAWING AND DESIGN ARE THE PROPERTY OF TIGG CORP. AND SHALL NOT BE REPRODUCED IN WHOLE OR IN PART, NOR EMPLOYED FOR ANY PURPOSE OTHER THAN SPECIFICALLY PERMITTED IN WRITING BY TIGG CORP. THIS DRAWING LOANED SUBJECT TO RETURN ON DEMAND.	
DRAWN BY	JB
DESIGN BY	BL
CHKD. BY	BL
DATE	9/24/02
SCALE	NTS



PLAN & ELEVATION

N-1200-PDB-1001 REV. 7